

RS6C-M

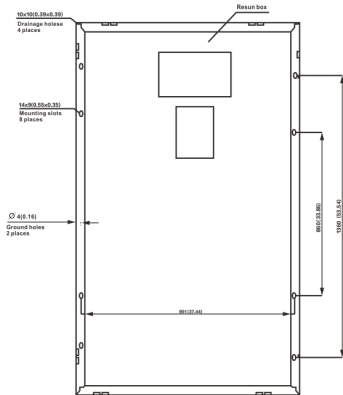

GLOBAL PROFESSIONAL PV PRODUCTS INTEGRATED SOLUTIONS SUPPLIER

Dimension of PV Modules Unit: mm

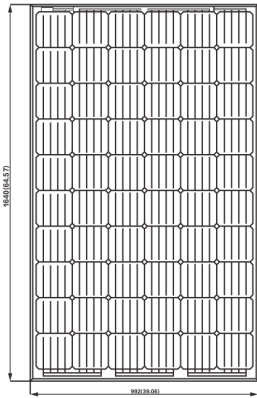

ELECTRICAL DATA(STC)

	250W	255W	260W	265W	270W	275W
Rated Power in Watts-Pmax(Wp)	250W	255W	260W	265W	270W	275W
Open Circuit Voltage-Voc(V)	37.10V	37.20V	37.40V	38.10V	38.60V	38.80V
Short Circuit Current-Isc(A)	8.74A	8.89A	9.02A	9.03A	9.07A	9.20A
Maximum Power Voltage-Vmp(V)	30.02V	30.11V	30.27V	30.85V	31.26V	31.40V
Maximum Power Current-Imp(A)	8.33A	8.47A	8.59A	8.59A	8.64A	8.76A
Module Efficiency (%)	15.37%	15.67%	15.98%	16.29%	16.60%	16.90%

STC: Irradiance 1000 W/m², Cell Temperature 25°C, Air Mass AM1.5 according to EN 60904-3.

ELECTRICAL DATA(NOCT)

	199W	203W	207W	211W	215W	219W
Maximum Power-Pmax (Wp)	199W	203W	207W	211W	215W	219W
Open Circuit Voltage-Voc (V)	36.55V	36.65V	36.85V	37.54V	38.05V	38.23V
Short Circuit Current-Isc (A)	6.98A	7.10A	7.20A	7.21A	7.24A	7.34A
Maximum Power Voltage-Vmp(V)	29.96V	30.04V	30.20V	30.77V	31.19V	31.33V
Maximum Power Current-Imp(A)	6.65A	6.76A	6.86A	6.86A	6.90A	6.99A

NOCT: Irradiance at 800 W/m², Ambient Temperature 20°C, Wind Speed 1 m/s.

MECHANICAL DATA

Solar cells	Mono-crystalline 156 x 156mm, 5 Bus bars
Cell configuration	60 cells(6x10)
Module dimensions	1640 x 992 x 40mm(64.6 x 39.1 x 1.38in)
Weight	19KGS
Front Cover	3.2mm Tempered Glass
Frame Material	Anodized Aluminum Alloy
J-BOX	IP67
Cable	4mm ² (IEC)/12AWG(UL),900mm
Connectors	MC4 or MC4 Comparable
Standard Packaging	26pcs/pallet

TEMPERATURE & MAXIMUM RATINGS

Nominal Operating Cell Temperature (NOCT)	45°C±2°C
Temperature Coefficient of Voc	-0.32%/°C
Temperature Coefficient of Isc	0.05%/°C
Temperature Coefficient of Pmax	-0.39%/°C
Operational Temperature	-40~+85°C
Maximum System Voltage	1000V(IEC)/600V(UL)
Max Series Fuse Rating	15A
Limiting Reverse Current	15A

PACKAGING CONFIGURATION

	40HQ	20GP
Number of modules per container	812pcs	312pcs
Package	26pcs/pallet,2pcs/carton box	26pcs/pallet
Package Number	28pallets + 42carton boxes	12pallets
Package Weight	490kg/pallet,37.8kg/carton box	490kg/pallet
Package Dimension	1680*1100*1120mm/pallet 1680*1020*90mm/carton box	1680*1100*1120mm/pallet

I-V characteristics at different irradiancies

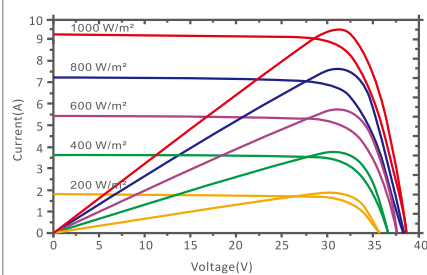

I-V characteristics at different temperature

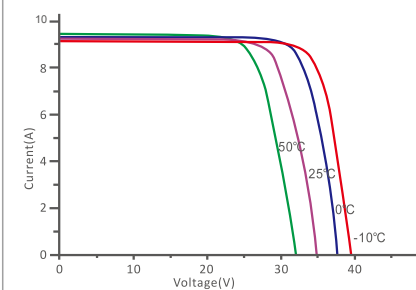



WWW.RESUNSOLAR.COM

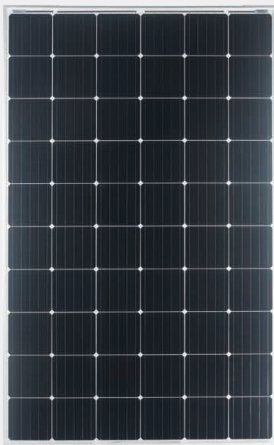

RS6C-M

RS6C-M is a robust solar module with 60 solar cells. These modules can be used for on-grid solar applications. Our meticulous design and production techniques ensure a high-yield, long-term performance for every module produced. Our rigorous quality control and in-house testing facilities guarantee Resun Solar's modules meet the highest quality standards possible.

60 Cells

Mono-crystalline

250-275W

Power output

16.90%

The Highest Efficiency

0~+5W

Tolerance

**0.5% Annual Degradation
over 30 years**

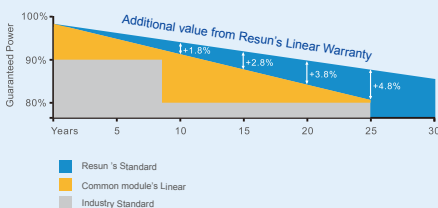

LINEAR PERFORMANCE WARRANTY
12 year Product Warranty / 30 year Linear Power Warranty



High module conversion efficiency (up to 16.90%), through superior manufacturing technology



Guaranteed 0-+5W positive power output tolerance ensures high reliability



Anti-reflective, hydrophobic coating improves light absorption and reduces surface dust



Excellent performance under low light environments (mornings, evenings and cloudy days)



Suitable for harsh environments, such as coasts, deserts and lakes. Withstand high level of wind loads (2400pa) and snow loads (5400pa)

Full range of products and certification systems

ISO 9001 TUV PID-FREE CE IEC61215/61730/61701/62716

