

RS6C-M

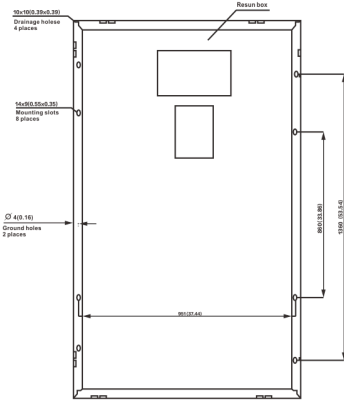

GLOBAL PROFESSIONAL PV PRODUCTS INTERGRATED SOLUTIONS SUPPLIER

Dimension of PV Modules Unit: mm

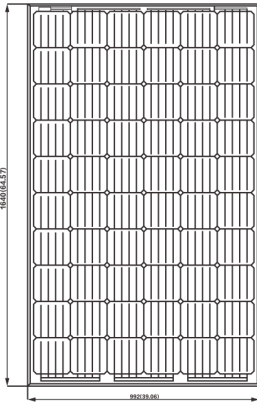

ELECTRICAL DATA(STC)

Rated Power in Watts-Pmax(Wp)	280W	285W	290W	295W	300W	305W
Open Circuit Voltage-Voc(V)	39.03V	39.12V	39.21V	39.30V	39.85V	40.53V
Short Circuit Current-Isc(A)	9.24A	9.32A	9.42A	9.52A	9.62A	9.73A
Maximum Power Voltage-Vmp(V)	31.70V	32.0V	32.30V	32.60V	32.90V	32.95V
Maximum Power Current-Imp(A)	8.85A	8.91A	8.98A	9.05A	9.12A	9.27A
Module Efficiency (%)	17.21%	17.52%	17.83%	18.13%	18.44%	18.74%

STC: Irradiance 1000 W/m², Cell Temperature 25°C, Air Mass AM1.5 according to EN 60904-3.

ELECTRICAL DATA(NOCT)

Maximum Power-Pmax (Wp)	223W	227W	231W	235W	239W	243W
Open Circuit Voltage-Voc (V)	38.51V	38.93V	39.18V	39.31V	39.42V	39.54V
Short Circuit Current-Isc (A)	7.42A	7.53A	7.62A	7.72A	7.83A	7.94A
Maximum Power Voltage-Vmp(V)	31.56V	31.65V	31.85V	31.96V	32.05V	32.15V
Maximum Power Current-Imp(A)	7.07A	7.18A	7.25A	7.35A	7.46A	7.56A

NOCT: Irradiance at 800 W/m², Ambient Temperature 20°C, Wind Speed 1 m/s.

MECHANICAL DATA

Solar cells	Mono-crystalline 156 x 156mm, 5 Bus bars
Cell configuration	60 cells(6x10)
Module dimensions	1640 x 992 x 40mm(64.6 x 39.1 x 1.38in)
Weight	19KGS
Front Cover	3.2mm Tempered Glass
Frame Material	Anodized Aluminum Alloy
J-BOX	IP67
Cable	4mm ² (IEC)/12AWG(UL),900mm
Connectors	MC4 or MC4 Comparable
Standard Packaging	26pcs/pallet

TEMPERATURE & MAXIMUM RATINGS

Nominal Operating Cell Temperature (NOCT)	45°C±2°C
Temperature Coefficient of Voc	-0.32%/°C
Temperature Coefficient of Isc	0.05%/°C
Temperature Coefficient of Pmax	-0.39%/°C
Operational Temperature	-40~+85°C
Maximum System Voltage	1000V(IEC)/600V(UL)
Max Series Fuse Rating	15A
Limiting Reverse Current	15A

PACKAGING CONFIGURATION

	40HQ	20GP
Number of modules per container	812pcs	312pcs
Package	26pcs/pallet,2pcs/carton box	26pcs/pallet
Package Number	28pallets + 42carton boxes	12pallets
Package Weight	490kg/pallet,37.8kg/carton box	490kg/pallet
Package Dimension	1680*1100*1120mm/pallet 1680*1020*90mm/carton box	1680*1100*1120mm/pallet

I-V characteristics at different irradiancies

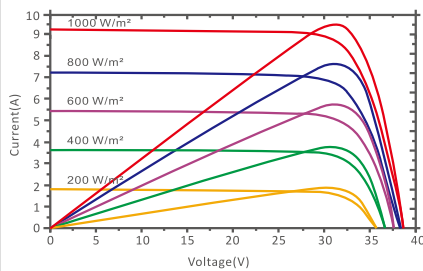

I-V characteristics at different temperature

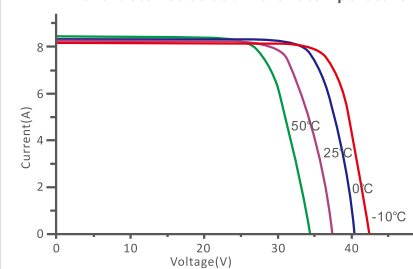



WWW.RESUNSOLAR.COM



RS6C-M

RS6C-M is a robust solar module with 60 solar cells. These modules can be used for on-grid solar applications. Our meticulous design and production techniques ensure a high-yield, long-term performance for every module produced. Our rigorous quality control and in-house testing facilities guarantee Resun Solar's modules meet the highest quality standards possible.

60 Cells

Mono-crystalline

280-305W

Power output

18.74%

The Highest Efficiency

0~+5W

Tolerance

**0.5% Annual Degradation
over 30 years**

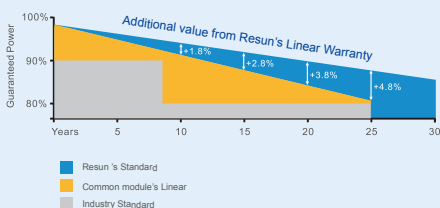

High module conversion efficiency (up to 18.74%), through superior manufacturing technology



Guaranteed 0-+5W positive power output tolerance ensures high reliability



Anti-reflective, hydrophobic coating improves light absorption and reduces surface dust



Excellent performance under low light environments (mornings, evenings and cloudy days)



Suitable for harsh environments, such as coasts, deserts and lakes. Withstand high level of wind loads (2400pa) and snow loads (5400pa)

Full range of products and certification systems

ISO 9001 TUV PID-FREE CE IEC61215/61730/61701/62716



LINEAR PERFORMANCE WARRANTY
12 year Product Warranty / 30 year Linear Power Warranty