

# RT8I-M-FB

**144 Cells**

Mono Half-Cell 9/16 BB

**530-580W**

Power output

**22.45%**

The Highest Efficiency

**0 ~ +5W**

Tolerance

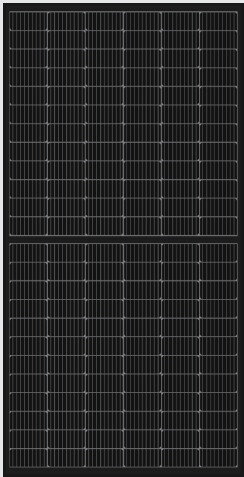

WWW.RESTARSOLAR.COM

## RT8IXXM FULL BLACK

RT8IXXM FULL BLACK HALF-CELL series is produced with high efficiency multi-busbar cells, which can reduce the module internal power loss to improve its conversion efficiency, as well as lower the failure risk caused by cracks and broken busbar to enhance the module reliability. Combined with half-cell technology, the module is highly resistant to hot-spot crisis caused by shadow effect. The full black design makes the module appearance outstanding and ideal for building installations.



### High Reliability

Multi-busbar technology can effectively reduce the reliability risk caused by cells cracks and broken busbar.



### Anti-PID Resistance

Prominent anti-PID performance reduces the power degradation, leading to higher energy yield and lower LCOE.



### Durability Against Extreme Conditions

Certified to resist high salt mist and ammonia conditions.



### High Efficiency

Multi-busbar technology can reduce the module internal power loss to improve the module conversion efficiency significantly.



### Low-Light Performance

With high transmittance and anti-reflective 3.2mm tempered glass, the module has stronger performance under low light circumstances.



### High Mechanical Strength

Certified to withstand: high wind load(2400Pa) and snow load(5400Pa).

## 0.5% Annual Degradation over 30 years

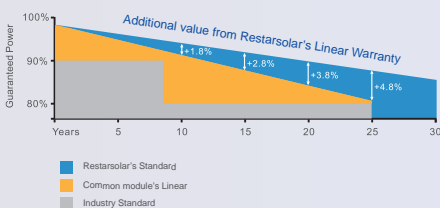

### LINEAR PERFORMANCE WARRANTY

**15 Year Product Warranty**

**30 Year Linear Power Warranty**

## Full range of products and certification systems

ISO 9001/14001 TUV PID-FREE CE IEC 61215/61730/61701/62716



**Dimension of PV Modules** Unit: mm

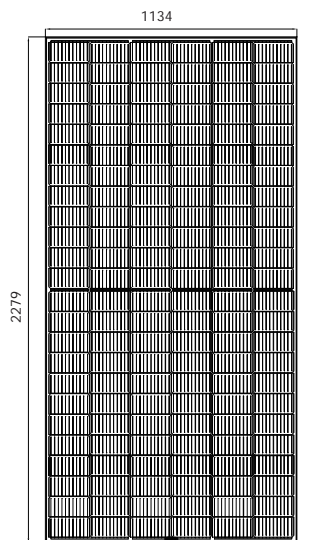

Front

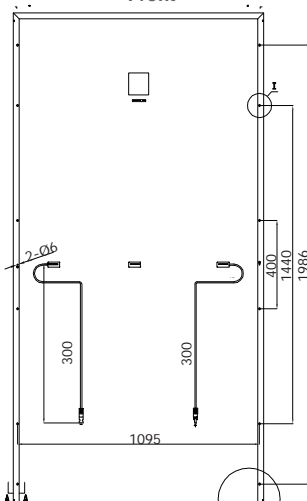

Back

**I-V CURVES OF PV MODULE(550W)**

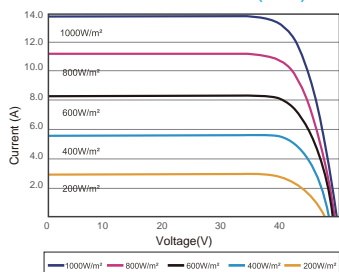

**P-V CURVES OF PV MODULE(550W)**

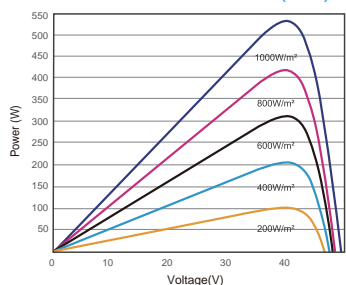

**ELECTRICAL DATA(STC)**

Photovoltaic module model	RT8I30M-FB	RT8I35M-FB	RT8I40M-FB	RT8I45M-FB	RT8I50M-FB	RT8I55M-FB	RT8I60M-FB	RT8I65M-FB	RT8I70M-FB	RT8I75M-FB	RT8I80M-FB
Rated Power in Watts-Pmax(Wp)	530	535	540	545	550	555	560	565	570	575	580
Open Circuit Voltage-Voc(V)	49.30	49.45	49.60	49.75	49.90	49.98	50.05	50.20	50.35	50.50	50.65
Short Circuit Current-Isc(A)	13.72	13.79	13.86	13.93	14.00	14.03	14.07	14.14	14.21	14.28	14.35
Maximum Power Voltage-Vmp(V)	41.31	41.47	41.64	41.80	41.96	42.06	42.12	42.26	42.42	42.57	42.72
Maximum Power Current-Imp(A)	12.83	12.90	12.97	13.04	13.11	13.19	13.30	13.37	13.44	13.51	13.58
Module Efficiency(%)	20.51%	20.70%	20.89%	21.09%	21.28%	21.48%	21.67%	21.87%	22.07%	22.26%	22.45%

STC: Irradiance 1000 W/m<sup>2</sup>, Cell Temperature 25°C, Air Mass AM1.5 according to EN 60904-3.

**ELECTRICAL DATA(NOCT)**

Maximum Power-Pmax(Wp)	401	405	408	412	416	420	424	428	432	436	440
Open Circuit Voltage-Voc (V)	16.18	46.31	46.43	46.55	46.68	46.78	46.85	46.98	47.11	47.33	47.46
Short Circuit Current-Isc(A)	11.01	11.05	11.09	11.13	11.17	11.20	11.24	11.28	11.32	11.36	11.40
Maximum Power Voltage-Vmp(V)	38.57	38.78	38.99	39.2	39.43	39.62	39.67	39.88	40.09	40.30	40.51
Maximum Power Current-Imp(A)	10.39	10.43	10.47	10.51	10.55	10.60	10.69	10.73	10.78	10.82	10.87

NOCT: irradiancia a 800 W/m<sup>2</sup>, temperatura ambiente 20 °C, velocidad del viento 1 m/s.

**MECHANICAL DATA**

Solar cells	Mono-crystalline 182*91mm, 9/16 Bus bars
Cell configuration	144 cells(6*24)
Module dimensions	2279*1134*35mm
Weight	28.6kg
Front Cover	3.2mm Tempered Glass
Frame Materia	Anodized Aluminum Alloy
J-BOX	IP68,3 Diodes
Cable	4mm <sup>2</sup> (IEC)/12AWG(UL), 300mm+300mm, or customized
Connectors	MC4 or MC4 Comparable
Standard Packaging	31pcs/pallet

**TEMPERATURE & MAXIMUM RATINGS**

Nominal Operating Cell Temperature(NOCT)	45°C±2°C
Temperature Coefficient of Voc	-0.26%/°C
Temperature Coefficient of Isc	0.048%/°C
Temperature Coefficient of Pmax	-0.32%/°C
Operational Temperature	-40~+85°C
Maximum System Voltage	1500V(IEC)/1500V(UL)
Max Series Fuse Rating	25A
Limiting Reverse Current	25A

**PACKAGING CONFIGURATION**

Number of modules per container	620 pcs/40HQ
Package	31 pcs/pallet
Package Number	20 pallets

Add: No: 30 Yongshun Road, Zhulin Town, Jintan District, Changzhou, Jiangsu Province, China  
 E-mail: sales@restarsolar.com  
 Web: www.restarsolar.com

**MADE IN CHINA**